

# HOLTKÖTTER INTERNATIONAL, INC.

155 Hardman Avenue South, South St. Paul, MN 55075

fax: (888) 552-8661 • phone: (800) 899-5444

www.holtkoetter.com

e-mail: customerservice@holtkoetter.com

## Shorten the Support Cord

1. Remove the cap of the counterweight (G) by unscrewing it from its base.
2. Loosen the screws (O) with the 1.5 mm allen wrench (N) to release the support cable.
3. Pull the cable (P) to the desired length.
4. Secure the screws (O) with the allen wrench.
5. Cut off the excess cable (P).
6. Screw the cap of the counterweight (G) back into place on the base.

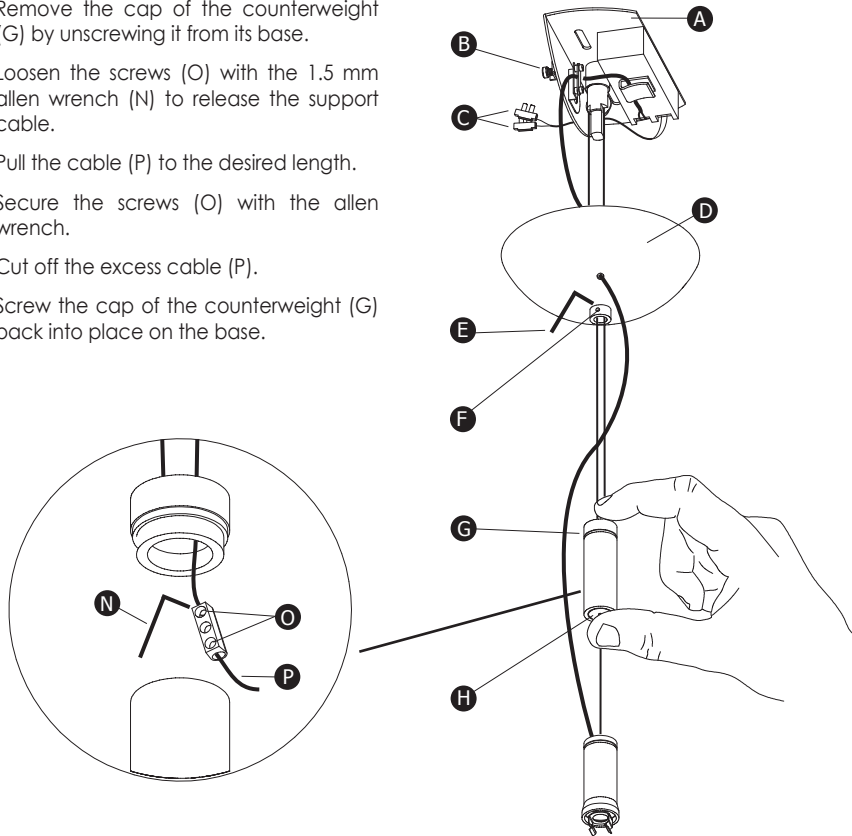

## ASSEMBLY INSTRUCTIONS FOR “Eve” No. 5631/1



### Care Instructions

Use only a soft, dry cloth to clean. If necessary, a slightly damp, soft cloth can be used to spot clean. Do not use common household cleaners on lamps or fixtures, as the lacquer on the outside of the brass may be damaged as a result. Enjoy your new Holtkötter lamp.

# HOLTKÖTTER INTERNATIONAL, INC.

www.holtkoetter.com  
e-mail: customerservice@holtkoetter.com

## Please make sure that the following parts for your fixture are enclosed:

1. Allen wrench, 2 mm
2. Allen wrench, 1.5 mm
3. Fixture
4. Black plastic wrench
5. Osram GU5.3, 12 Volt / 35 Watt Decostar ECO (1 each)

## IT IS FIRMLY RECOMMENDED THAT A LICENSED ELECTRICIAN INSTALL THIS FIXTURE.

### Installation (See Diagram on back)

1. Disconnect the power to the outlet box.
2. Remove the crossbar strap (A) from the canopy (D) by loosening the set screw (F) from the canopy (D) using the 2 mm allen wrench (E).
3. Mount the crossbar strap (A) to the outlet box.
4. Connect the wires from the pendant with the wires in the outlet box according to generally accepted electrical standards.
5. Slide canopy (D) back into place and secure with the set screw (F) loosened in Step 2. Be sure to prevent the cable from being trapped in the canopy.
6. Attach the reflector (J) to the fixture at the nut (K), finger-tight, with the black plastic wrench (L) provided. The reflector must remain slightly loose on the cable.
7. Install the bulb (M). Use only Osram GU 5.3, 12V/35W Decostar ECO.

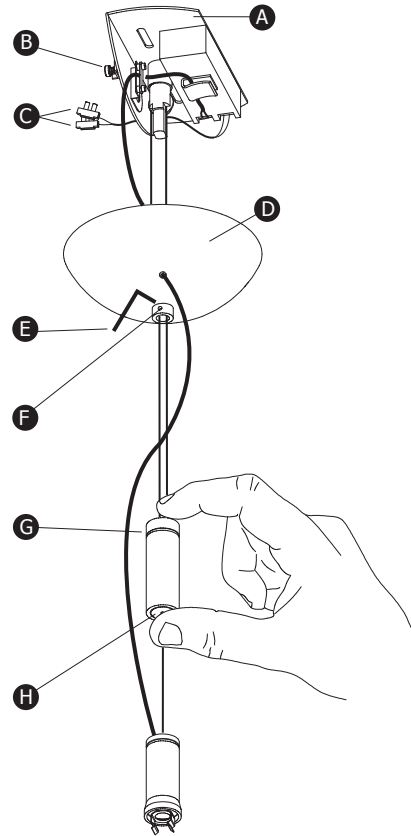

### Adjusting the Height of the Pendant

1. Locate the button (H) inset in the lower part of the counterweight (G).
2. Simultaneously press the button and slide the pendant up or down to achieve the proper height.

# ASSEMBLY INSTRUCTIONS FOR No. 5631/1 - "Eve"

### Balance the Reflector

1. If the reflector (J) hangs at a slight angle, it can be straightened by adjusting where the aluminum nut (K) is holding the reflector.
2. Slide the reflector side-to-side for proper adjustment.

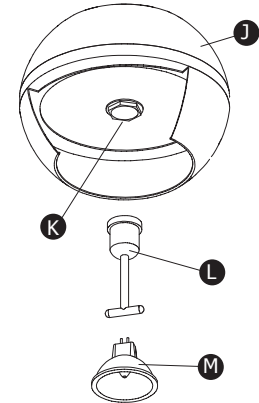

### Replace the Bulb

1. Disconnect the power to the pendant prior to replacing the bulb.
2. Remove the old bulb.
3. Install a new Osram GU5.3, 12V/35W Decostar ECO bulb.

### Shorten the Coaxial Cable

1. Loosen the nut (Q) to release the cable.
2. Slide the cable (R) up or down to the correct height.
3. Prior to closing the canopy, carefully roll up the excess cable so that it will not get pinched or shorted when reassembling the canopy.

