

Be sure to check all packing material carefully for small parts, which may have come loose inside the carton during shipment.

Component And Hardware List

Top Assembly	Mounting plate	Post	Base		
(A) 1 PC.	(B) 1 PC.	(C) 1 PC.	(D) 1 PC.		
Bolt Ø5/16" x 2 1/2"	Bolt Ø5/16" x 1"	Flat Washer Ø5/16"	Spring washer Ø5/16"	5mm Allen Wrench	Levelers
(E) 4 PCS.	(F) 8 PCS.	(G) 12 PCS.	(H) 12 PCS.	(I) 1 PC.	(J) 4 PCS.

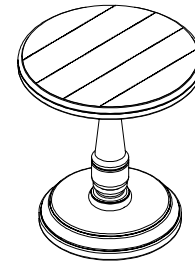

Round End Table
#37509

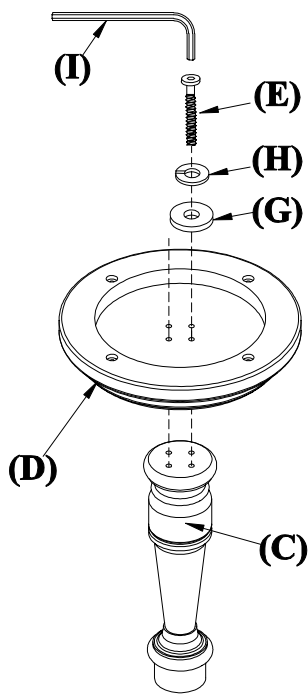

DETAIL A

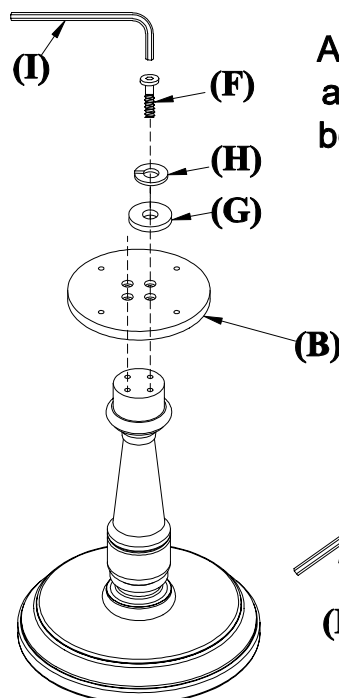

DETAIL B

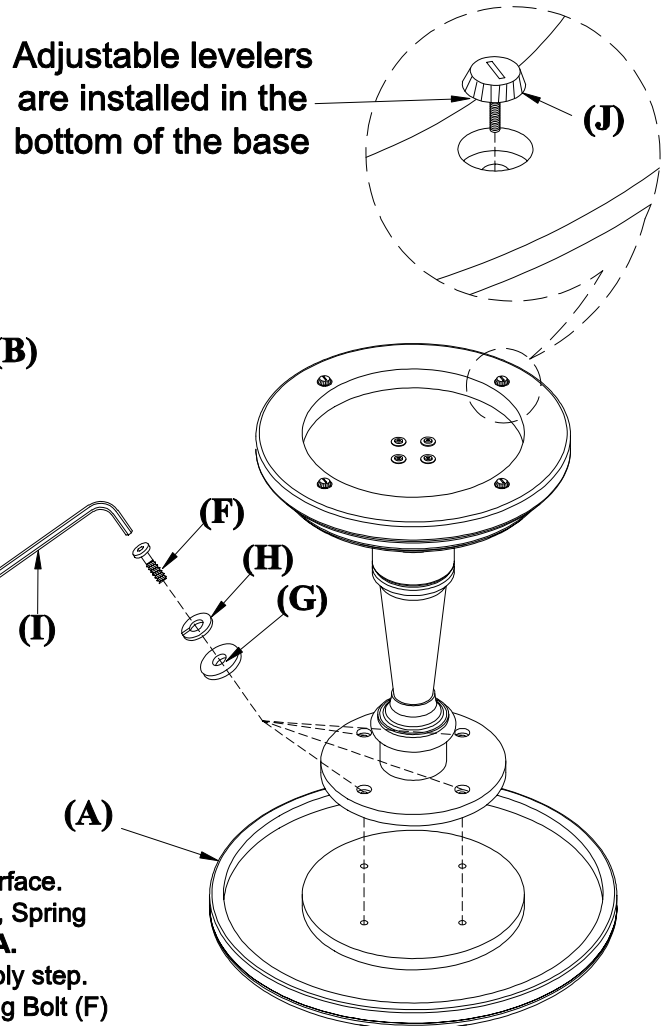

DETAIL C

ASSEMBLY PROCEDURE:

1. Place the Top Assembly (A) on a soft and smooth surface.
2. Assemble Base (D) to the Post (C) by using Bolt (E), Spring Washer (H) & Flat Washer (G) as shown in **DETAIL A**.
Tighten bolts with Allen Wrench (I) after each assembly step.
3. Assemble Mounting Plate (B) to the Post (C) by using Bolt (F) Spring Washer (H) & Flat Washer (G) as shown in **DETAIL B**.
4. Assemble base post and top assembly (A) by using Bolt (F) Spring Washer (H) & Flat Washer (G) as shown in **DETAIL C**.
5. Turn the assembled table upright.

THANK YOU FOR YOUR PURCHASE.