



User Manual

C400, C300, C200

3314 West Main • Houston, TX 77098 • 888.827.1675 • info@coolazone.com



www.coolazone.com

Table of Contents

Transportation	Page 3
Installation & Set-Up	Page 4
Operating Procedures	Page 5-8
Storage	Page 8
Care & Cleaning	Page 9
Safety	Page 10
Parts	Page 11
Specifications	Page 12
Applications	Page 13
CE Certificate	Page 14
Contact Information	Page 15
Product Registration	Page 16



Transportation

TRANSPORTATION:

When the fan is being transported, avoid any impact or collision, or applying excessive weight to the unit. Excessive weight could damage the unit under these circumstances.

Moving State



Unlocked Caster

Fixed State



Locked Caster

Installation & Set-Up

INSTALLATION:

If the fan is placed close to a wall or other obstacle, keep a distance of 3 feet between the wall or obstacle and the face of the cooling pads.

When placing the fan, take the following into consideration:

- a. Uninterrupted fresh air should be made available to the cooling pad side of the unit. Please do not use the fan in a closed area.
- b. Avoid blocking the air output (front) side of the fan. Cool air released from the unit should be able to freely circulate within an open area.
- c. In order to prevent air from being re-circulated, ensure that the area to be cooled is properly ventilated.

Rear / Cooling Pad Side

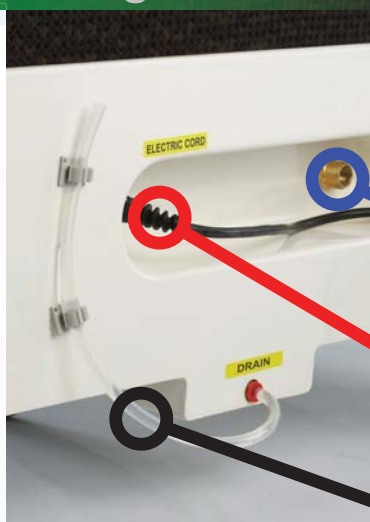

Water Inlet

Electric Cord

Drain Line

Front / Fan Side



Water Valve

If you have placed the unit at a location where it is inconvenient to connect the water inlet to a water source, you may pour clean water into the back of the unit.

A full sump tank supply the necessary water for about 3 hours.

Operating Procedures

ADJUSTMENT OF THE WATER FLOW & USER'S POSITION:

When the water flow first starts, ensure that the spray bar, located above the cooling pads, is evenly distributing water over the pads at a slow drip. Use the "SPRAY BAR ADJUSTMENT" valve on the front of the unit to make any water flow adjustments.

When proper adjustments are made, a slow drip should be enough water to keep the pads soaked. Note that excessive water flow can reduce efficiency in air cooling. With proper adjustment, cooling capacity will be increased.

New pads in the unit require a 'breaking-in' period for up to one week, before optimal efficiency can be achieved.

Front / Fan Side



Water Valve
"SPRAY BAR ADJUSTMENT"

Valve Control



Counter Clockwise:
Increases Water Flow

Clockwise:
Decreases Water Flow

Operating Procedures

THE AUTO CONTROL SYSTEM:

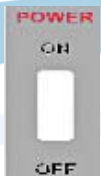
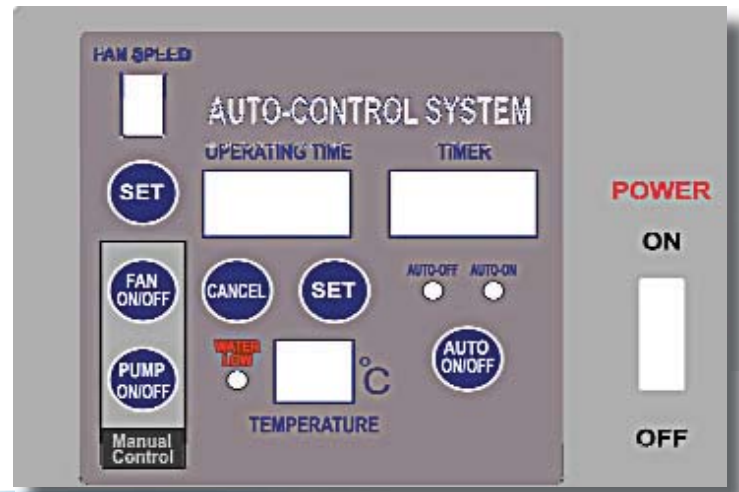

Power (Emergency Stop)

To ensure that the fan is functioning normally, first turn on the power switch. The unit should make a short beeping sound, and all lights on the control panel should flash once. "Temperature Display" is now ready for use.



Auto Control

Automatic Start: Push the "AUTO ON/OFF" button. Water pump starts when "AUTO ON" lights up. A timer counts down from 30 seconds while the pump sprinkles water over the cooling pads, after 30 seconds the fan automatically starts.



Operation Timer

Each short push on the "SET TIMER" button programs 5 minutes of operating time. Press the "SET TIMER" button for 3 seconds to program 1 hour of operating time.

After the set operating time has expired, the unit goes into auto shut-down mode whereby the water pump shuts down, a 15 minute timer is activated, and the fan continues to blow to dry the cooling pads. When the 15 minute timer is complete, the unit powers down.

For example, if 4 hours of operating time is required, only 3 hours and 45 minutes is needed when setting the timer. After the operating timer has expired, the unit will activate the automatic shut off system.

Automatic Shut Off System

Press the "AUTO ON/OFF" button to manually turn off the fan. When pressed, the unit will activate the automatic shut-off system whereby the water pump shuts down, "AUTO OFF" lights up, a 15 minute timer is activated and the fan continues to blow to dry the cooling pads. When the 15 minute timer is complete, the unit powers down.

Operating Procedures

THE AUTO CONTROL SYSTEM (CONTINUED):



Fan Speed Setting

The C-300 fan offers 5 speeds. The C-200 and C-400 fans each offer 3 different speeds.

The High (HI) and Low (LO) Speed Levels of your particular Cool-A-Zone model will depend not just on the model, but on the date of manufacturing as well. Consult the handy chart below to find your Cool-A-Zone speed specifications.

 HIGH (HI) / LOW (LO) SPEED SETTINGS CHART		YOUR COOL-A-ZONE WAS MANUFACTURED...		
		BEFORE 1 JAN 2010	1 JAN 2010 TO 31 DEC 2010	AFTER 1 JAN 2011
YOUR COOL-A-ZONE MODEL IS...	C-400	HI - LEVEL 3 LO - LEVEL 1	HI - LEVEL 1 LO - LEVEL 3	HI - LEVEL 1 LO - LEVEL 3
	C-300	HI - LEVEL 5 LO - LEVEL 1	HI - LEVEL 5 LO - LEVEL 1	HI - LEVEL 1 LO - LEVEL 5
	C-200	HI - LEVEL 1 LO - LEVEL 3	HI - LEVEL 1 LO - LEVEL 3	HI - LEVEL 1 LO - LEVEL 3

Before switching between speeds, allow the unit to reach the full speed of the current setting. For example, to switch from "Speed 1" to "Speed 2", wait until "Speed 1" is at its full speed, then press the "FAN SPEED SET" button to advance to "Speed 2". Same procedure follows for Speeds 3-5.



Manual Control

- To Power Up: First turn on the pump, then the fan.
- To Shut Off: First shut off the pump, then the fan.
- To turn the pump on or off, push the "PUMP ON/OFF" button.
- To turn the fan on or off, push the "FAN ON/OFF" button.

Turn off the power switch once the pump and motor have stopped. After starting the automatic operation system, if there is a need to switch the pump or fan on/off, press the pump or fan on/off button on the Manual Control Panel.

To turn the pump or fan on/off while the automatic operation system is in use, press the "PUMP ON/OFF" or "FAN ON/OFF" button on the Manual Control Panel.

Turn off the power switch once the pump and motor have stopped.

Operating Procedure & Storage

OPERATING PROCEDURES (CONTINUED):



Temperature Display

When the power is turned on, the temperature of the air being emitted by the fan will be displayed here.



Water Low

When the water level in the tank is too low to circulate in the system, the warning will be shown here. The water pump will automatically shut down if the water level gets too low.

Control System & the Fuse Box



The unit has two fuses for safety: one for the fan motor and one for the water pump. In the event the fan or water pump stops working, the fuses should be checked to ensure they are intact.

**DISCONNECT
POWER
BEFORE
WORKING
WITH THE
FUSE BOX!**

In order to access the fuse box, remove the control panel cover. Begin by peeling the cover off at each of the four corners to expose the screws. Unscrew and remove the control panel. The fuses will be in plain view. Replace any damaged fuses and replace the control panel by reversing the steps above. **NOTE: UNPLUGGING THE UNIT WHILE POWERED ON COULD BLOW A FUSE.**

Storage

To store the fan

1. Drain and clean the sump tank. Be sure that the pads and sump tank are completely dry.
2. Roll up and secure the power cord.
3. Store the fan in a dry area.

To drain the sump tank

1. Power down the unit.
2. Bend the drain pipe downward to let water out.
3. After the water has stopped flowing, place the drain pipe back into the holding clamps.

Draining the Sump Tank



Care and Cleaning

MAINTENANCE:



**DISCONNECT POWER
BEFORE REMOVING
COOLING PADS!**

To inspect the sump tank: disconnect the power cord, drain the sump tank, and remove the cooling pads. Debris will collect in the sump tank over time. Remove any debris with a clear cloth or shop vacuum.

To access the cooling pads for inspection and cleaning, remove the metal flap at the top back of the fan. Begin by tilting out the center pad from the top while lifting it out of the drain trough. To remove the two sides, pads, first pull them toward the middle of the unit until they pass the side retainer. Then continue with the same procedure used to remove the center pad.

An inlet strainer is located on the bottom of the pump and should be inspected and cleaned periodically.

Cleaning the Cooling Pads

Please make sure the electric power is turned off and cord disconnected from the outlet.

Removing the cooling pads:



After using the unit for a period of time, the pads should be removed for cleaning. Use clean water and a brush if necessary to clean the cooling pads. Do not use any soap or detergent to clean the pads.

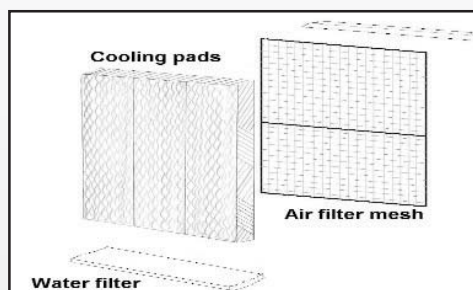

Safety



**DISCONNECT POWER
BEFORE REMOVING
COOLING PADS !**



SAFETY GUIDELINES

Do not attempt to remove the front grill or louvers, or use any tool to insert and touch the blade while the unit is in operation.

When opening the back side for cleaning, please make sure that the unit is powered off and the power cord is disconnected from the power source.

Only personnel who are properly trained should undertake electrical/electronic troubleshooting and repair.

Do not alter or bypass protective interlocks.

Before operating the unit, read and observe all warning labels.

When troubleshooting, make sure the unit is powered off and the power cord is disconnected from the power source.

Take extra precaution in damp areas to protect yourself from accidental electric shock.

Before turning the power on, be sure that nothing is obstructing the fan blade.

Do not remove the control panel unless it is necessary to inspect the fuses.

Replace components **ONLY** with components acquired from Cool-A-Zone or an authorized dealer.

Do not wear metal frame glasses, metallic necklaces, or any accessories such as rings, watches, and bracelets while working on electrical equipment.

Parts

PARTS LISTING

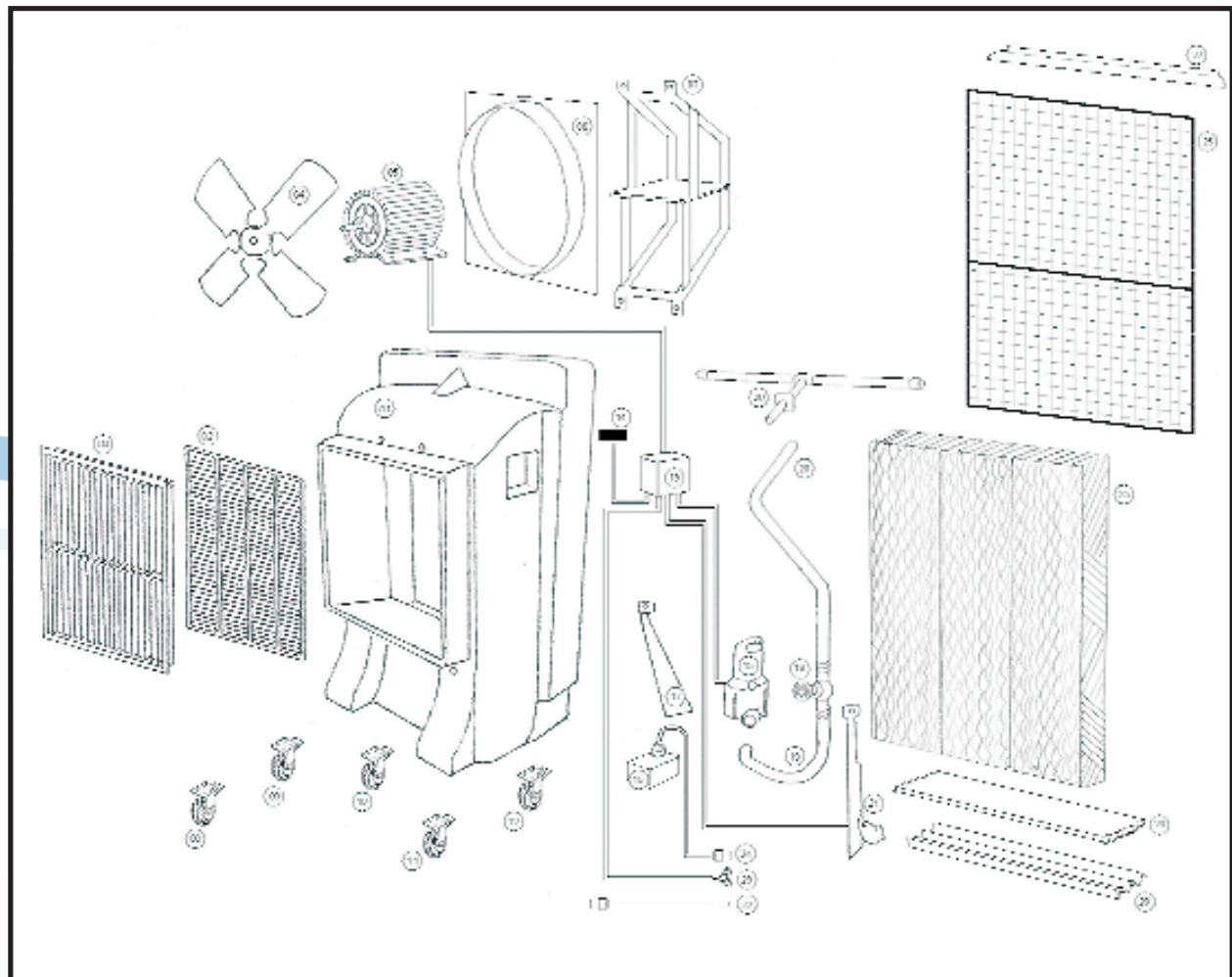

Part #	Description	Part #	Description
01	Fiberglass Housing	17	Buoy Stand
02	Fan Gril	18	Valve
03	Louver	19-20	Inside Pipes
04	Blade	21	Water Level Sensor
05	Motor	22	Drain
06	Director	23	Electric Cord
07	Motor Seat	24	Water Inlet
08-12	Wheels	25	Cooling Pads
13	Control Box	26	Air Filter Mesh
14	Temperature Sensor	27	Water Block
15	Pump	28	Cooling Pads Brace
16	Buoy	29	Water Filter
		30	Spray Pipe

Specifications



C-400



C-300

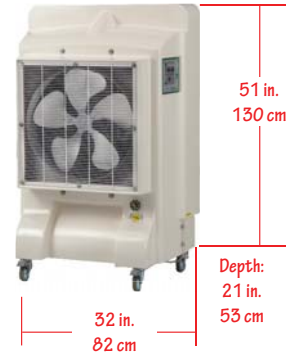

C-200

	Three Speeds
Cooling Capacity	4,000 sq. ft.
Maximum Air Delivery	15,000 CFM
Fan Motor	1 HP / 110 V - 1 HP / 220V
Pump	0.3 HP / 110V - 0.3HP / 220V
Water Reservoir	37 gallons
Width	56 in. / 142 cm
Height	77 in. / 195 cm
Depth	31 in. / 80 cm
Unit Weight	249 lbs. / 113 kg
Shipping Weight	282 lbs / 128 kg
Est. Units (40' Container)	23

	Five Speeds
Cooling Capacity	2,500 sq. ft.
Maximum Air Delivery	10,000 CFM
Fan Motor	1/2 HP / 110 V - 1/2 HP / 220V
Pump	0.3 HP / 110V - 0.3HP / 220V
Water Reservoir	23 gallons
Width	42 in. / 107 cm
Height	67 in. / 170 cm
Depth	26 in. / 66 cm
Unit Weight	165 lbs. / 75 kg
Shipping Weight	178 lbs / 81 kg
Est. Units (40' Container)	50

	Three Speeds
Cooling Capacity	2,000 sq. ft.
Maximum Air Delivery	7,500 CFM
Fan Motor	1/3 HP / 110 V - 1/3 HP / 220V
Pump	0.3 HP / 110V - 0.3HP / 220V
Water Reservoir	15 gallons
Width	32 in. / 82 cm
Height	51 in. / 130 cm
Depth	21 in. / 53 cm
Unit Weight	122 lbs. / 55 kg
Shipping Weight	132 lbs / 60 kg
Est. Units (40' Container)	104

How Cool-A-Zone Works

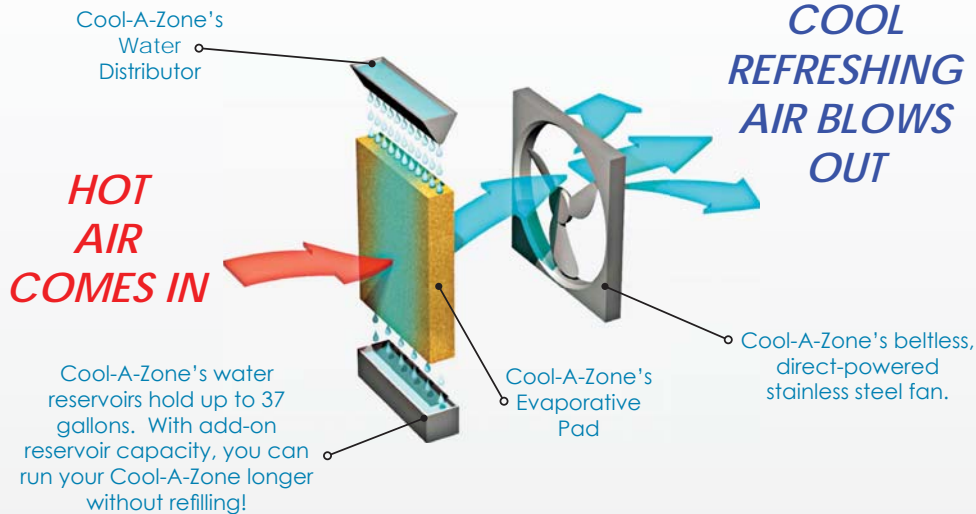

Applications

MAIN FUNCTIONS:

Cool-A-Zone is designed to cool environments where traditional A/C is unavailable or cost-prohibitive. These units are ideal for warehouses, sporting event sidelines for teams, and aesthetically designed for use in outdoor patios and outdoor weddings, there are myriad of uses for Cool-A-Zone, such as (but not limited to):

- Industrial / Warehousing
- Manufacturing & Fabrication Shops
- Agricultural
- Military
- Sports & Recreation
- Special Outdoor Events
- Restaurants & Bars
- Automotive / Aviation
- Home & Patio
- Emergency & Disaster Relief
- OSHA Compliance



CE Certificate



EUROPEAN INSPECTION AND CERTIFICATION COMPANY S.A.
TATOIOU 73 & CHAR. TRIKOPI, KIFISIA 14564, TEL: 210-6252495, FAX: 210-6203018
email: info@eurocert.gr, site: www.eurocert.gr

CERTIFICATION No: CN.CE.0021-10/07

CERTIFICATE OF CONFORMITY

EUROCERT is a Notified Body for Machinery Directive with Identification No. CE 1128

Following your relevant application and the attached Technical File which will be kept at the files of EUROCERT SA with regard to the certification of the following type of machines:

Manufacturer : CHIEF EXECUTIVE INDUSTRIES CORP.
Address : 127, 1ST ROAD, TAICHUNG INDUSTRIAL PARK, TAICHUNG
TAIWAN ,R.O.C
Machine : EVAPORATIVE COOLING UNIT
Model : CC26D5, CC36D, CCI6D
TCF No. : CE-2007-A1

According to the European Directive 98/37/EC article 8 paragraph 2 and European Low Voltage Directive 2006/95/EC, following the formation of the Technical File and the Declaration of Conformity, which clearly states that it meets the basic prerequisites regarding the safety and health of Appendix I of the above European Directive, your company is obligated to affix the above equipment with the CE marking as follows:

Date of Issue – 16/10/2007

CE



Contact Information

ENGINEERED BY CURTISON INTERNATIONAL, INC. in USA

MANUFACTURED EXCLUSIVELY BY:
CHIEF EXECUTIVE INDUSTRIES CORP. IN TAIWAN

DISTRIBUTED EXCLUSIVELY BY:
COOL-A-ZONE

Cool-A-Zone
3314 West Main
Houston, TX 77098

info@coolazone.com

coolazone.com

Toll-Free 888.827.1675
Phone 713.968.9860
Fax 713.513.5279



Product Registration

MODEL:

___ C400 ___ C300 ___ C200



COLOR: _____

SERIAL NUMBER: _____

DATE PURCHASED: _____

FIRST NAME: _____

LAST NAME: _____

COMPANY: _____

ADDRESS 1: _____

ADDRESS 2: _____

CITY: _____ STATE: _____ ZIP: _____

COUNTRY: _____

WAYS TO REGISTER YOUR PRODUCT:

1. Fax this form to Cool-A-Zone at: 713.513.5279
2. Scan and email this form to Cool-A-Zone at: info@coolazone.com
3. Fill out the form online: www.coolazone.com
4. Mail this form to:
3314 West Main
Houston, TX 77098



Cool-A-Zone
info@coolazone.com
888.827.1675
3314 West Main
Houston, TX 77098



www.coolazone.com